



Securo®



# SPECIFICATIONS

Sec. : Securo®  
Date : May 2022



# SPECIFICATIONS



# Securo® - Overview



## Securo® Overview



**Securo®** is an Italian designed specialised roller blind with 7 models. The main function of Securo® is to provide shelter from the elements: wind, rain, sun and heat. Depending on which **Securo®** model suits your requirements, the **Securo®** can be installed either as an exterior or interior product.

The key to this innovative robust interior/exterior

**Securo®** product is how the fabric is locked (Securo®) into the roller tube, channel guides and bottom aluminium rail. This locking method ensures that the fabric is held in place during inclement weather. The Securo® Pull Down, Channel Guide 75 & 110 systems have been designed for winds up to 65km/h and Securo® Max (up to 4.6m wide) is designed for winds up to 65km/h (over 4.6m wide) is designed for winds up to 35km/h.

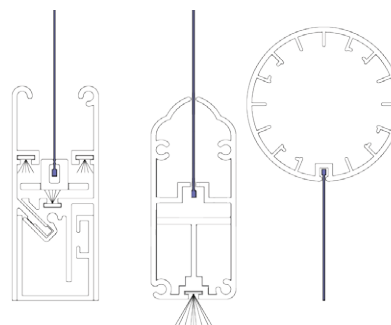

Channel Guide Bottom Rail Roller Tube

The versatility of **Securo®** provides for various control options such as crank, chain or motorisation with a variety of different head box sizes and an optional stainless steel wire guide.

These robust features and the fully enclosed head box to protect the fabric, makes **Securo®** the most advanced and stylish interior/exterior roller blind on the market.

Model Types:	Application:	Maximum Width Guidelines (Width)	Operation:
Securo® Pull Down	Interior & Exterior	2.4m - 2.7m	Manual - Handle
Securo® Channel Guide 75	Interior	3.9m	Motorised, Crank Handle
Securo® Channel Guide 110	Interior	4.6m	Motorised, Crank Handle
Securo®Max Channel Guide	Interior	10m	Motorised
Securo®Max Wire Guide	Interior	10m	Motorised
Securo® Channel Guide 75	Exterior	3.9m	Motorised, Crank Handle
Securo® Wire Guide 75	Exterior	3.9m	Motorised, Crank Handle
Securo® Channel Guide 110	Exterior	4.6m	Motorised, Crank Handle
Securo® Wire Guide 110	Exterior	4.6m	Motorised, Crank Handle
Securo®Max Channel Guide	Exterior	10m	Motorised
Securo®Max Wire Guide	Exterior	10m	Motorised
Securo®Side Roll	Interior/Exterior	4.0m	Manual - Side Pull with Brake

## Applications:

**Interior** - Selecting from a variety of fabrics such as Sunscreen, Light-filtering, Block-out or Insect Screen, Securo® blinds are ideally suited to computer rooms, offices, home theatre, room dividers and bedrooms. Securo® blinds offer insect control, sun and heat control and when required a complete block-out to a room.



## Operation:

**Securo®** has 4 options for raising and lowering:

1. **Handle** - **Securo®** Pull Down is controlled manually by pulling up and down using a handle on the bottom rail.
2. **Crank** - **Securo®** Channel and Wire Guide (75 & 110) for internal or external applications are controlled by a crank handle. For security reasons or to stop an unwanted guest operating the **Securo®**, a magnetic cardan joint crank handle allows for the easy removal and storage of the crank handle whilst not in use.
3. **Motor** - for both **Securo®** and **Securo®** Max Channel and Wire Guide systems which can be linked to a building management system or remote controlled with optional light and wind sensors.
4. **Manual side-pull with brake** - **Securo®** Side Roll

Sec. : Securo  
Date : Sep 2021



# Securo® Pull Down

## Securo® Pull Down Blind

Securo® Pull Down blinds are designed for small to medium sized interior and exterior windows and doors providing solutions for Insect control, complete block-out, glare control and protection from wind and rain.

The key to this innovative robust interior & exterior roller blind is how the fabric is locked (Securo®) into the roller tube within the aluminium cassette housing, bottom rail and side channel guides. The Securo Pull Down incorporates a locking spline which is welded to the fabric on all four sides using a high impulse electric welding machine. The fabric is guided into the head and bottom rails and side channels through a specially formed locking groove.

Securo® Pull Down is easily operated manually, by raising and lowering the blind using the handle or pull cord located on the bottom rail. Fabric tension is created with a spring inserted in the top tube and the blind can be locked into the down position by simply tilting the bottom rail.

These robust and versatile features makes Securo® Pull Down the most advanced channel roller blind system on the market for small to medium sized windows and doors.

**Application :** Interior & Exterior

### Maximum Sizes for 60mm Housing system:

Phiferglass Pool & Patio Mesh - 2400mm wide x 2000mm Drop  
Block Out (interior) & Screen fabric (Soltis 88) – 2100mm wide x 2000mm Drop

### Minimum Sizes for 60mm Housing system:

Phiferglass Pool & Patio Mesh - 450mm wide x 450mm Drop

### Maximum Sizes for 80mm Housing system:

Phiferglass Pool & Patio Mesh - 2700mm wide x 2550mm Drop  
Block Out (interior) & Screen fabric (Soltis 88) – 2700mm wide x 2550mm Drop

### Minimum Sizes for 80mm Housing system:

Phiferglass Pool & Patio Mesh - 600mm wide x 600mm Drop

### Operation

: Manual

### Fixing

: Top or Face Fix

### Fabric options

: Exterior : Phiferglass Pool & Patio Mesh, Soltis 88 Screen

Interior : Phiferglass Pool & Patio Mesh, Soltis 88 Screen,

Icon FR Block-out, Duo Block

Note: not suitable for Clear PVC

### Cassette Housing

: Aluminium 60mm x 60mm x 80mm fully enclosed 2 piece cassette aluminium head box protecting the roller tube and fabric.

**Standard Colours for Aluminium Profiles :** Gun Metal, Perla, White, Matte Black, and Custom



Sec. : Securo  
Date : May 2022

# Securo® Pull Down



1a. 60mm Cassette Housing

2a. Tube : Aluminium Ø35mm Securo® Locking Groove

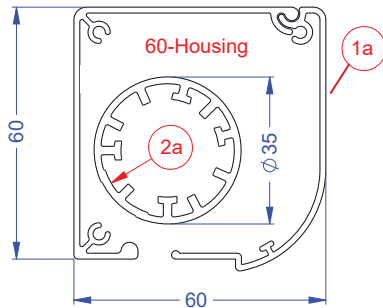

1b. 80mm Cassette Housing

2b. Tube : Aluminium Ø48mm Securo® Locking Groove

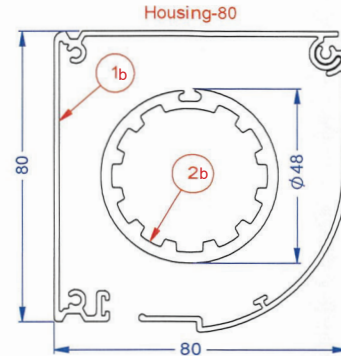

3a. Bottom Rail for 60mm housing system : Aluminium  
1 piece 21mm x 45mm Securo® locking Groove  
with Soft Touch

Note: For Face Fix installations an additional profile (fig 6) is required.

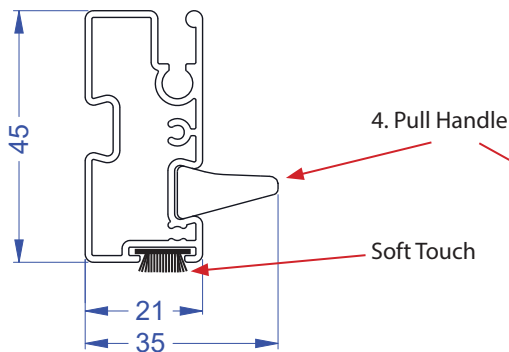

3b. Bottom Rail for 80mm housing system : Aluminium  
1 piece 21mm x 45mm Securo® locking Groove with  
Soft Touch

Note: For Face Fix installations an additional profile (fig 6) is required.

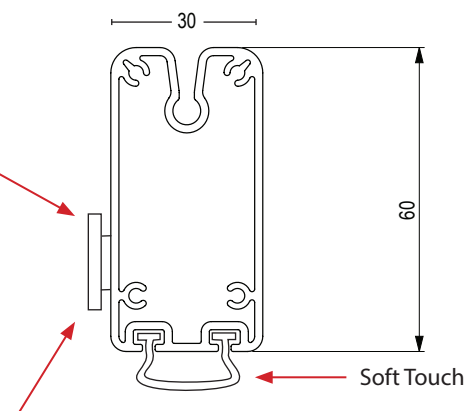

5. Side Channel Guide for 60mm & 80mm Cassette Housing versions

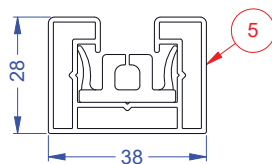

6. Sill (Installations where there is no sill to drop the bottom rail onto). For 60mm & 80mm Cassette Housing versions

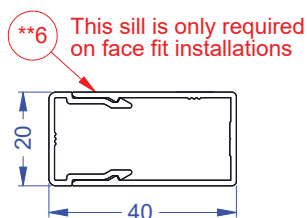

7. Side Channel Packer for 60mm & 80mm Cassette Housing versions

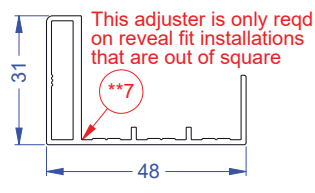

**Standard Colours for Aluminium Profiles :** Gun Metal, Perla, White, Matte Black, and Custom

Sec. : Securo  
Date : Aug 2022

Cross Section of typical Face Fix installation:

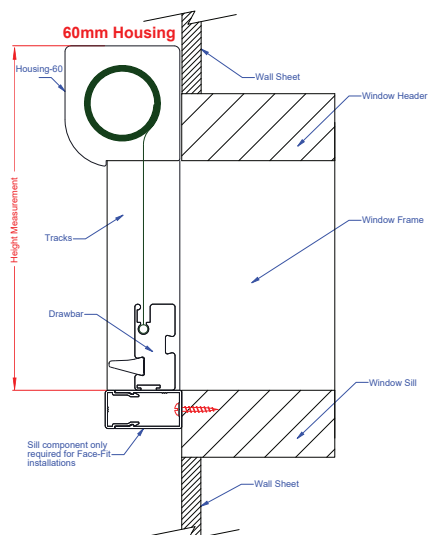

Cross Section of typical Top Fix installation (inside fit):

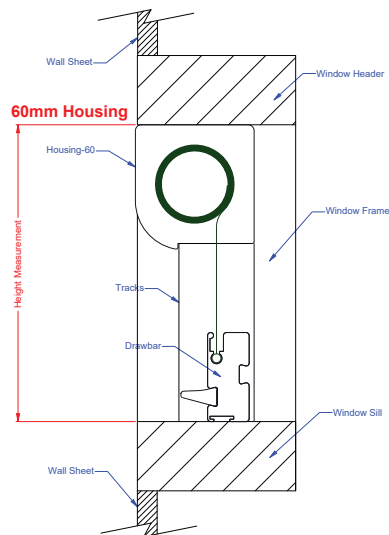

80mm Housing

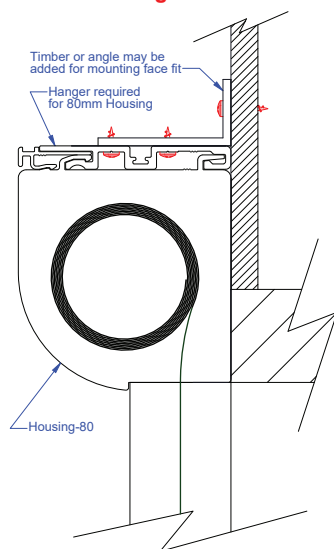

80mm Housing

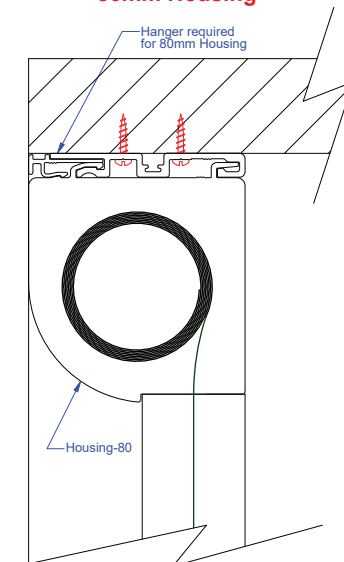

Plan view of Face Fix:

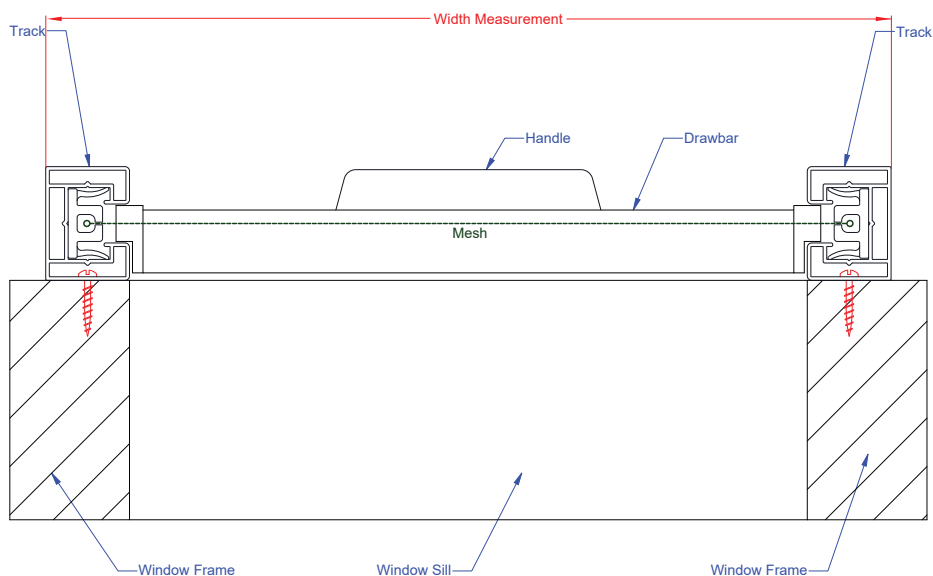

# Securo® Pull Down



Plan view of Top Fix (inside fit):

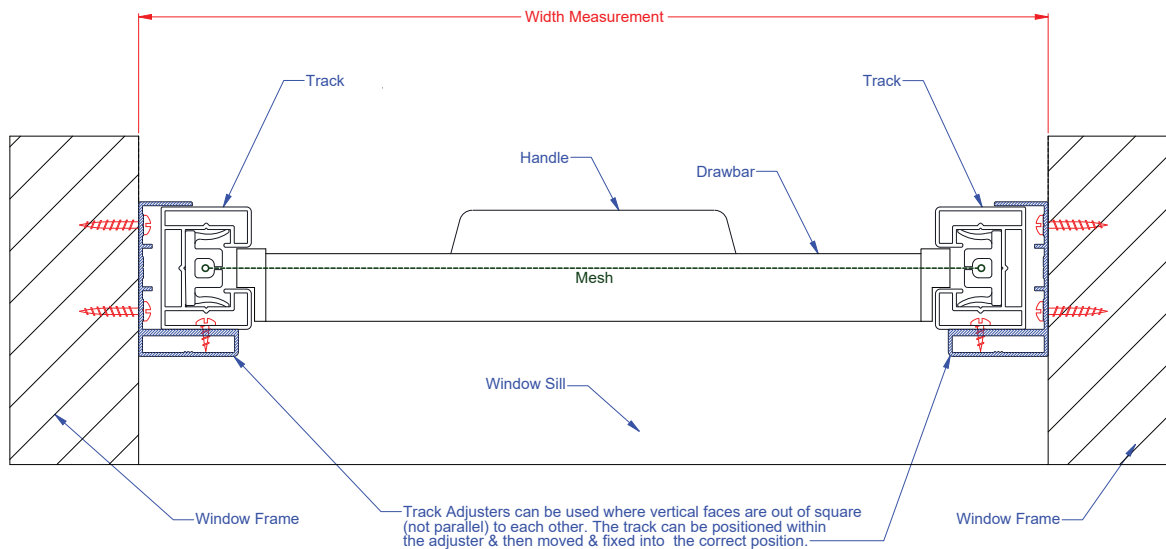

Example for Corner installations:

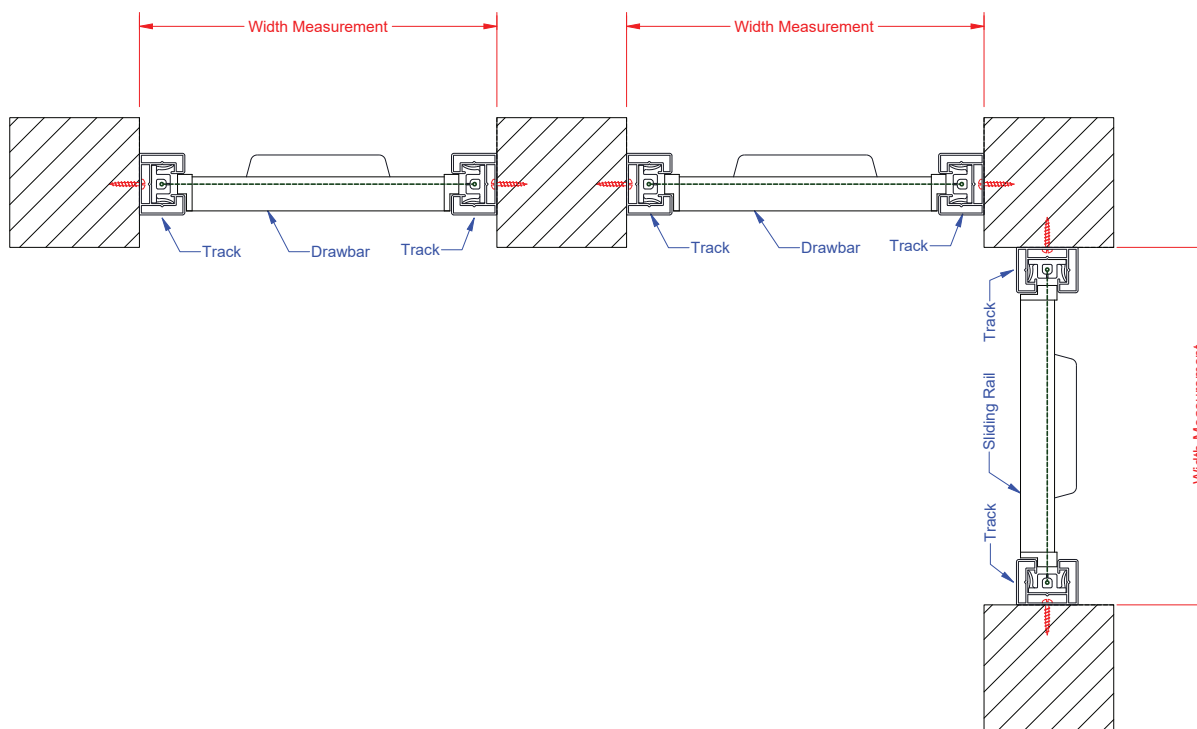

Sec. : Securo  
Date : Sep 2020

SPECIFICATIONS



# Securo® - Channel Guide 75 & 110

## Securo® Channel Guide 75, Securo® Channel Guide 110

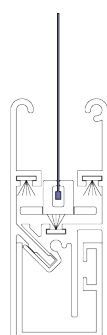
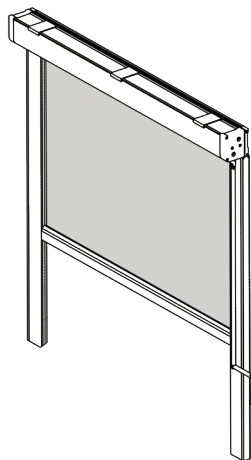

Channel Guide

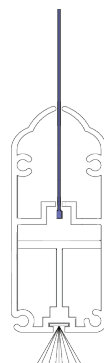

Bottom Rail

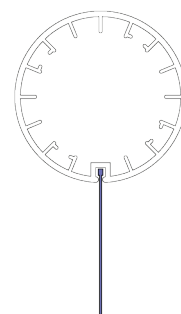

Roller Tube

**Application** : Interior or Exterior

**Maximum Size** : For Securo Channel Guide 75 - 3.9m wide x 1.3m drop (drop subject to fabric selection)  
For Securo Channel Guide 110 - 4.6m wide x 3.0m drop (drop subject to fabric selection)

**Operation** : Crank Handle or Motorised  
Securo® Channel Guide can be linked to a building management system, remote controlled and with wall switches with optional light & wind sensors



**Fixing** : Top or Face Fix

**Material Type (Interior)** : Sunscreen, Light-filtering, Block-out  
(Exterior) : Techno X

**Head Box Options**

- 110mm x 138mm 2 piece cassette is recommended for use with all fabrics including clear PVC. The two piece cassette box provides ease of maintenance and assembly.
- 75mm x 75mm 1 piece cassette for narrow reveals recommended for all fabrics except PVC.
- All fascia panels have a 7mm diameter drainage hole at each end of the fascia

138mm x 110mm

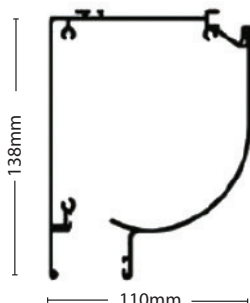

75mm x 75mm

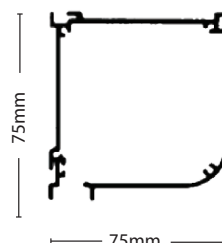

**Tube**

: Outer Tube Options:  
Aluminium Ø63mm,  
Steel Ø70mm (steel tube for motorised blinds only)  
Inner Tube Ø40mm  
Inner Motorisation Tube Ø40mm  
Securo® Locking Groove

Outer Tube

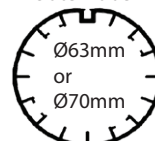

Inner & Inner Motor Tube





# Securo® - Channel Guide 75 & 110



## Channel Guide

: Aluminium  
4 pieces on each side  
Securo® Locking Groove  
Lip Seal  
Face Fix 33mm x 63mm  
Side Fix 25mm x 63mm

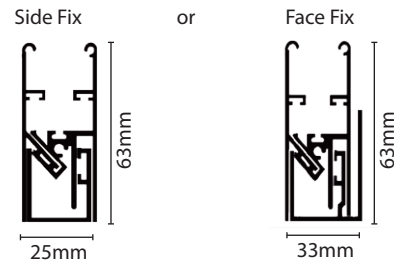

## Channel Guide Optional

: Aluminium  
2 pieces on each side  
PVC only  
No Securo® Locking Groove  
Lip Seal

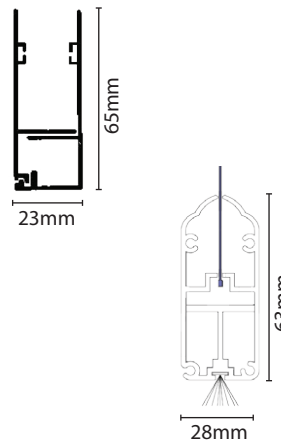

## Bottom Rail

: Aluminium  
1 piece  
Securo® Locking Groove  
Lip Seal  
Soft Touch

## Securo® Gear

: Case : Zinc Aluminium  
Screw Worm : Aluminium  
Crown : Brass  
Gear Ratio : 5/5  
Nickel Brass Magnetised Cardan Joint complete with bell coupling

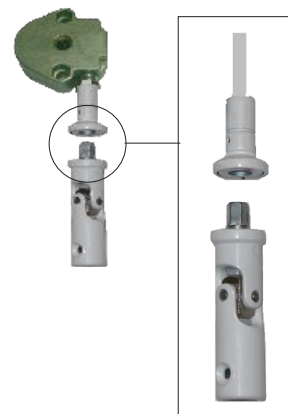

## Crank Handle

: Crank Handle with aluminium tube  
Colours available: White, Black

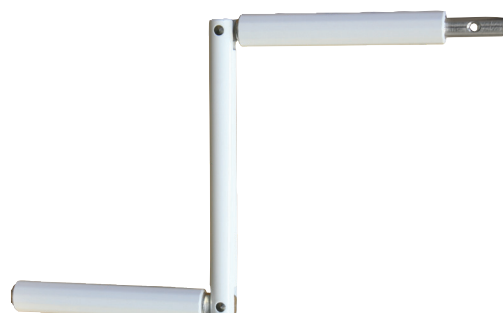

SPECIFICATIONS

Sec. : Securo  
Date : Nov 2018

# Securo® - Wire Guide Options

## Securo® Wire Guide Options

**Crank Handle 90° transmission through frame** : Nickel Brass Cardan Joint complete with bell coupling  
Nylon Case  
Colours available: White, Black

**Crank Handle Magnetic Cardan Joint** : Colours available: White, Black

**Fixed Crank Handle Holder** : Nylon Case  
Colours available: White, Black

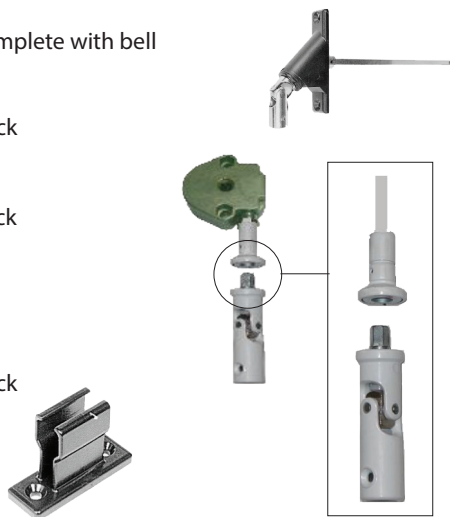

## Securo® Wire Guide 75, 110

Available in 2 sizes:

### Size:

Securo® Wire Guide 75  
Securo® Wire Guide 110

### Maximum Width:

3.9m  
4.6m

### Operation:

Crank Handle or Motorised  
Crank Handle or Motorised

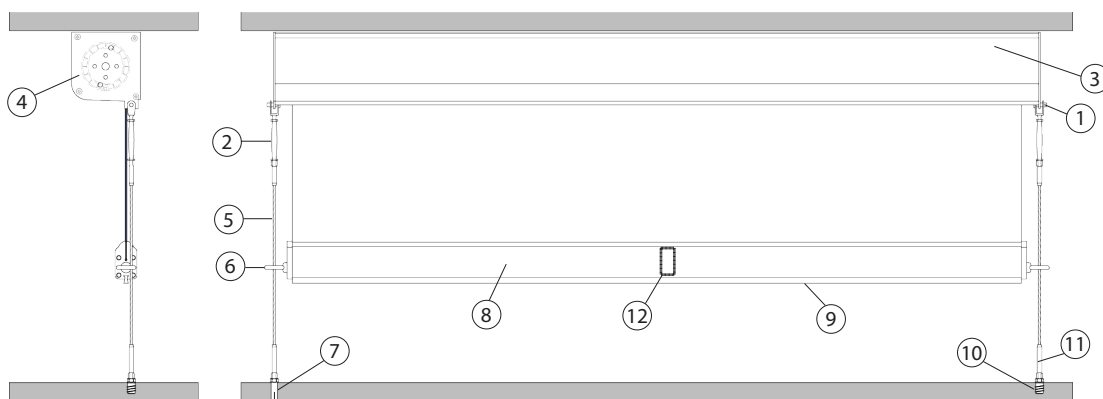

### Key Numbers

- |   |                                       |
|---|---------------------------------------|
| 1. Eyelet                                   | : Stainless Steel 316                 |
| 2. Jaw/Swage Pipe Turnbuckle                | : Stainless Steel S3121P M6/3.0       |
| 3. Head Box                                 | : Aluminium                           |
| 4. End Cap                                  | : Powder Coated over Galvanised Steel |
| 5. 3mm Stainless Steel Cable Wire           | : Stainless Steel 7 x 19 ASIST316     |
| 6. Eye Bolt                                 | : Stainless Steel 316                 |
| 7. Drop in Anchor (Concrete Fixing)         | : Stainless Steel 316                 |
| 8. Bottom Rail                              | : Aluminium                           |
| 9. Soft Touch                               | : Polybond Woolpile                   |
| 10. Counter Sunk Socket Screw (wood fixing) | : Stainless Steel 316                 |
| 11. Swage Stud                              | : Stainless Steel S7801 3mm x M6 316  |
| 12. Stabilising Bolt (optional)             | : Stainless Steel                     |

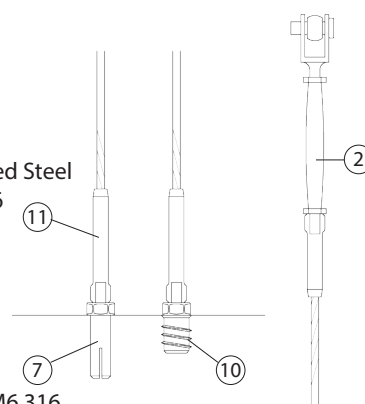

# Securo® - Channel Guide 75 & 110



## Securo® Channel Guide 75, Securo® Channel Guide 110, Specifications

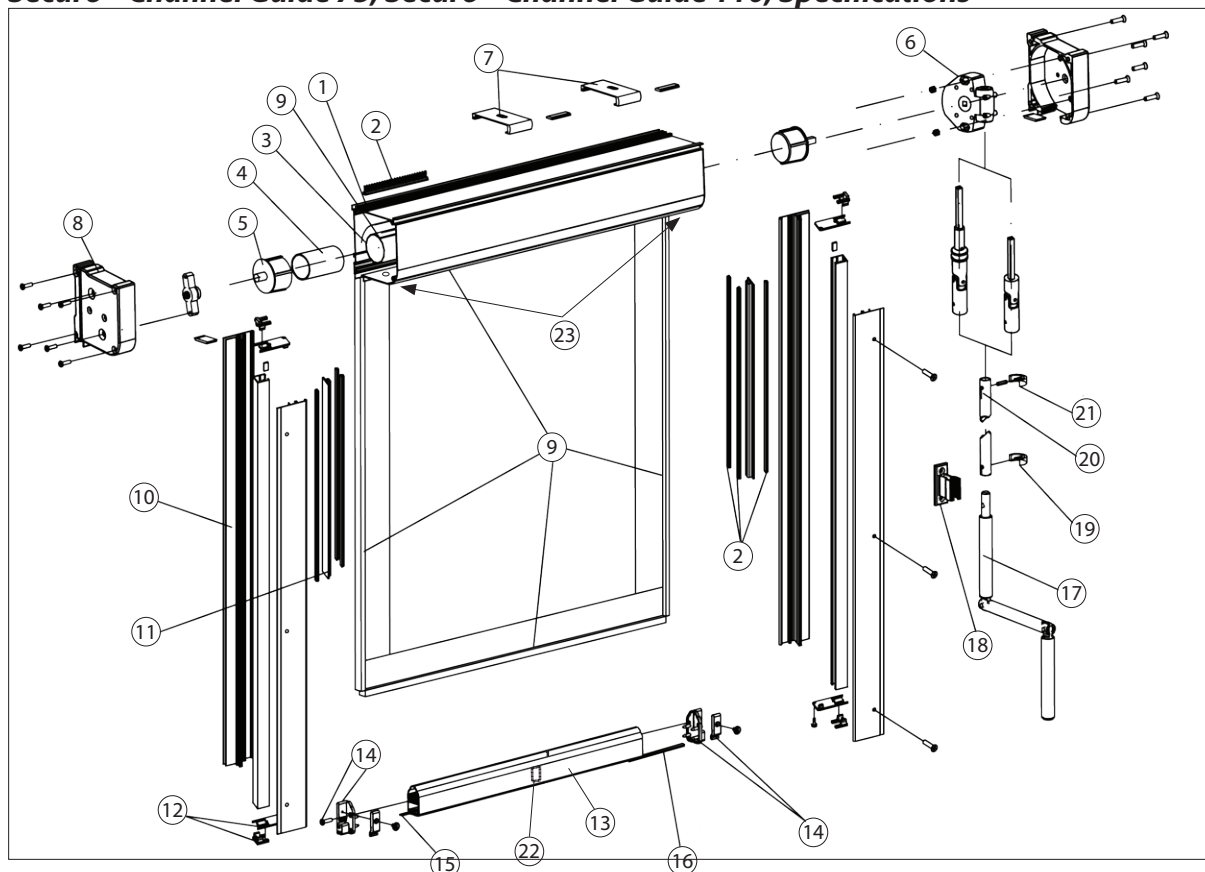

### Key Numbers

1. Aluminium Head Box  
Colours available: Gun Metal, Perla, White, Matt Black
2. Lip Seal
3. Aluminium Roller Tube Ø 63mm with Securo® Locking Groove, or  
Ø70mm Steel Tube (steel tube for motorised blinds only)
4. Aluminium Roller Tube Ø 40mm
5. Round Hub Pivot Ø 10mm
6. Gear 5/5 Ratio with standard Magnetic Cardan Joint
7. Zinc Plated Wall Ceiling Fixing Bracket
8. End Caps Nylon - Colours available: Black, White
9. Securo® Locking Spline (Head Rail, Channel Guides, Bottom Rail)
10. Aluminium Channel Guides (3 Profiles)  
Colours available: Gun Metal, Perla, White, Matt Black
11. Channel Guides PVC
12. Channel Guide Plastic End Caps
13. Bottom Rail Aluminium  
Colours available: Gun Metal, Perla, White, Matt Black
14. Bottom Rail Plastic End Caps
15. Galvanised Iron Plate
16. Soft Touch - Polybond Woolpile
17. Crank Handle
18. Fixed Crank Handle Holder
19. Ring
20. Aluminium Roller Tube Ø 13mm
21. Ring with Pin
22. Stabilising Bolt (optional) Stainless Steel
23. Drainage holes (7mm Dia)

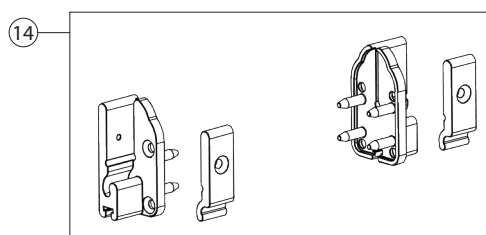
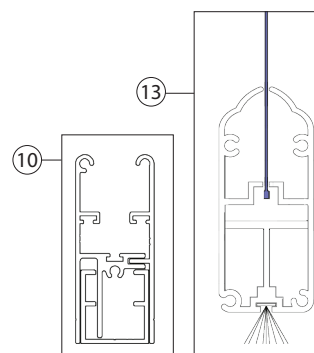

Sec. : Securo  
Date : Dec 2020

## Securo® Channel Guide 75 & 110 Motorisation Specifications

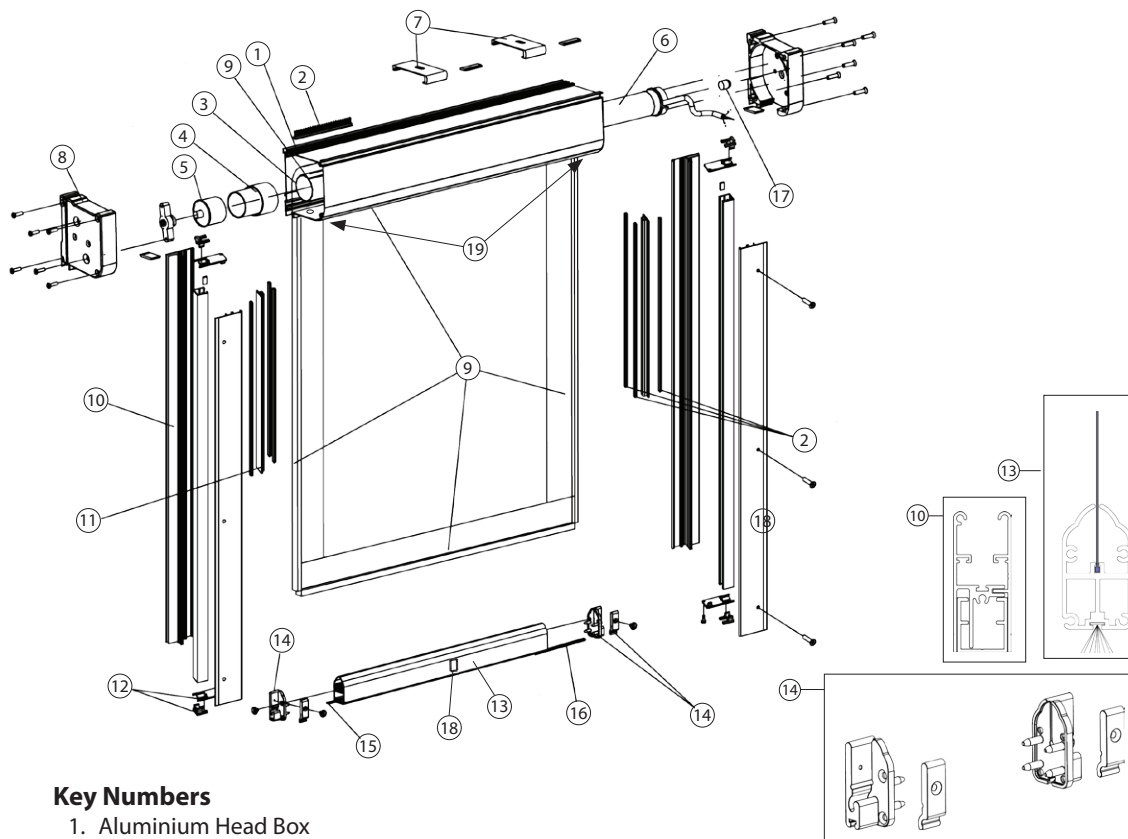

### Key Numbers

1. Aluminium Head Box  
110 x 138 & 75 x 75 Motorisation  
Colours available: Gun Metal, Perla, White, Matt Black
2. Lip Seal
3. Aluminium Roller Tube Ø 53mm with Securo® Locking Groove, or Ø70mm Steel Tube
4. Aluminium Roller Tube Ø 40mm for electric 220V Somfy Motor
5. Round Hub Pivot Ø 10mm
6. Somfy Motor 220V
7. Zinc Plated Wall Ceiling Fixing Bracket
8. End Caps Nylon - Colours available: Black, White
9. Securo® Locking Spline (Head Rail, Channel Guides, Bottom Rail)
10. Aluminium Channel Guides (3 Profiles)  
Colours available: Gun Metal, Perla, White, Matt Black
11. Channel Guides PVC
12. Channel Guide Plastic End Caps
13. Bottom Rail Aluminium  
Colours available: Gun Metal, Perla, White, Matt Black
14. Bottom Rail Plastic End Caps
15. Galvanised Iron Plate
16. Soft Touch - Polybond Woolpile
17. Pivot for Motor
18. Stabilising Bolt (optional) Stainless Steel
19. Drainage holes (7mm Dia)

### Motorisation option - Securo® 75-110 Channel Guide/Wire Guide

Motor Selection		<6m <sup>2</sup>	>6m <sup>2</sup>
Securo 75-110	RTS	Maestria 6/17	Maestria 10/17
	WT	Ariane 6/17	Jet 10/117

### KEY:

WT = Mechanical switch hardwired to the motor.

RTS = Remote control (handheld or wallmounted)

Maximum Width: 4.6m, Maximum Drop: 3.0m (subject to fabric choice)

Performances	Maestria 6/17	Maestria 10/17	Ariane 6/17
Torque	6 Nm	10 Nm	6 Nm
Nominal Voltage	230v	230v	230v
Rated Current	0.45 A	0.5 A	0.4 A
Rated Power	105W	120W	90W
Speed	17 RPM	17 RPM	17 RPM
Thermal Protection	4 Min	4 Min	4 Min
Radio Frequency	433.42	433.42	-
Sound Level (DB)			46
Cable Length	3000mm	3000mm	2500mm
IP Rating	IP 44	IP 44	IP 44
Insulation Class	I	I	I

Sunis Wirefree  
RTS Sun Sensor

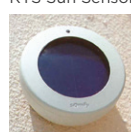

Eolis RTS Wind Sensor



Soliris RTS- Sun & Wind  
Sensor



### Somfy Sensors

Weather Sensors can be used for automatic control. These include wind and sun sensors. Wind sensors will retract your Securo® if wind speeds exceed 50 km/h. The sun sensor works on light levels and can be programmed to a specific light level.

Sec. : Securo  
Date: Jun 2020



# Securo® - Wire Guide 110, 75 Crank Handle



## Securo® Wire Guide 110, 75 Crank Handle

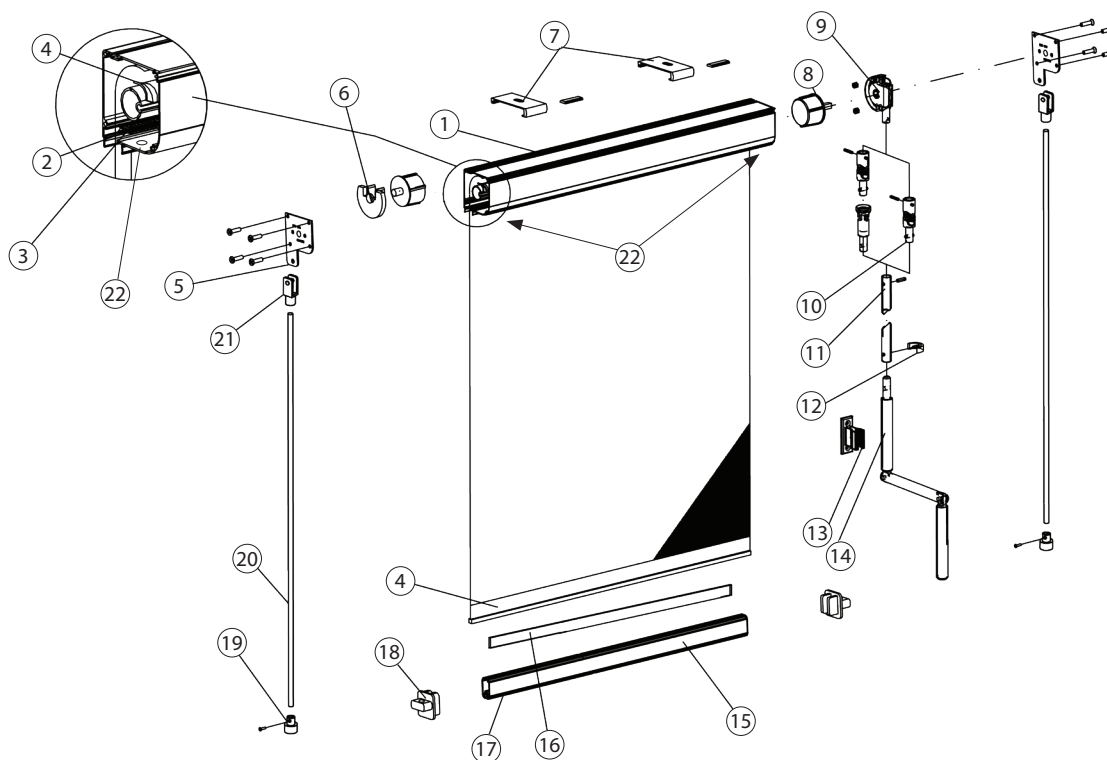

### Key Numbers

1. Aluminium Head Box  
Colours available: Gun Metal, Perla, White, Matt Black
2. Lip Seal
3. Aluminium Roller Tube Ø 53mm with Securo® Locking Groove and inner Aluminium Roller Tube Ø 40mm, or or Ø70mm Steel Tube (steel tube for motorised blinds only)
4. Zip
5. End Cap Powder Coated over Galvanised Steel
6. Nylon Support
7. Zinc Plated Wall Ceiling Fixing Bracket
8. Hub Pivot Ø 10mm
9. Gear 5/5 Ratio with standard Magnetic Cardan Joint
10. Nickel Brass Cardan Joint
11. Aluminium Crank Handle Tube Ø 10mm
12. Ring with Pin
13. Fixed Crank Handle Holder - Colours available: Black, White
14. Crank Handle - Colours available: Black, White
15. Bottom Rail Aluminium  
Colours available: Gun Metal, Perla, White, Matt Black
16. Galvanised Iron Plate
17. Soft Touch - Polybond Woolpile
18. Bottom Rail Plastic End Caps (Colours available: Black, White), with Stainless Steel Eye Bolt
19. Stainless Steel Swage Stud with either;
  - Counter Sunk Socket Screw for Wood Fixing
  - Drop in Anchor for Concrete Fixing
20. 3mm Stainless Steel Wire
21. Stainless Steel Fork Swage
22. Drainage holes (7mm Dia)

Sec. : Securo  
Date : Dec 2020

SPECIFICATIONS

# Securo® Max - Channel Guide

## Securo® Max Channel Guide

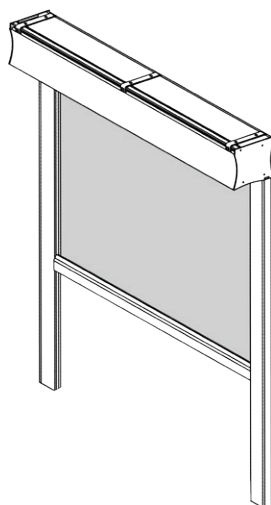

**Securo®Max Channel Guide** is a revolutionary new addition to the market. Italian designed, **Securo®Max** Channel Guide is the solution for extra large exterior roller blinds.

**Securo®Max Channel Guide** when motorised, can be linked to a building management system, remote controlled and/or with wall switches. Window Treatments is an authorised Somfy Automation Specialist. For further information on the type of motors, switches and power requirements, please contact [motorisation@window-treatments.co.nz](mailto:motorisation@window-treatments.co.nz)

<b>Application</b>	: Exterior/Interior
<b>Maximum Size</b>	: 10m wide x 3.0m drop
<b>Operation</b>	: Motorised

**Securo® Max** can be linked to a building management system, remote controlled and/or with wall switches with optional light and wind sensors



<b>Fixing</b>	: Top or Face Fix
<b>Material Type</b>	: Techno X – durable and tough synthetic FR fabric made of PVC coated polyester designed for outdoor use
<b>Head Box</b>	: Fully enclosed 2 piece cassette Aluminium head box protecting the roller tube and motor Roller Tube with Securo® Locking Groove Lip Seal Innovative PVC Cradle for supporting the roller tube

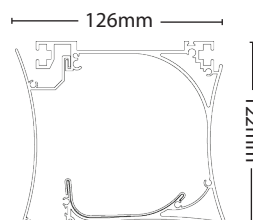

### Adjustable Galvanised Steel End Caps and PVC Cradle

One of the key features of Securo®Max is that it can be manufactured up to 10m wide. This is made possible due to the vertical slide movement of the adjustable galvanised steel end caps. This end cap feature distributes the weight of the Techno X fabric evenly over the aluminium roller tubes. This feature is also enhanced by the innovative PVC cradle that supports the Techno X fabric and tube over the entire width of the blind.

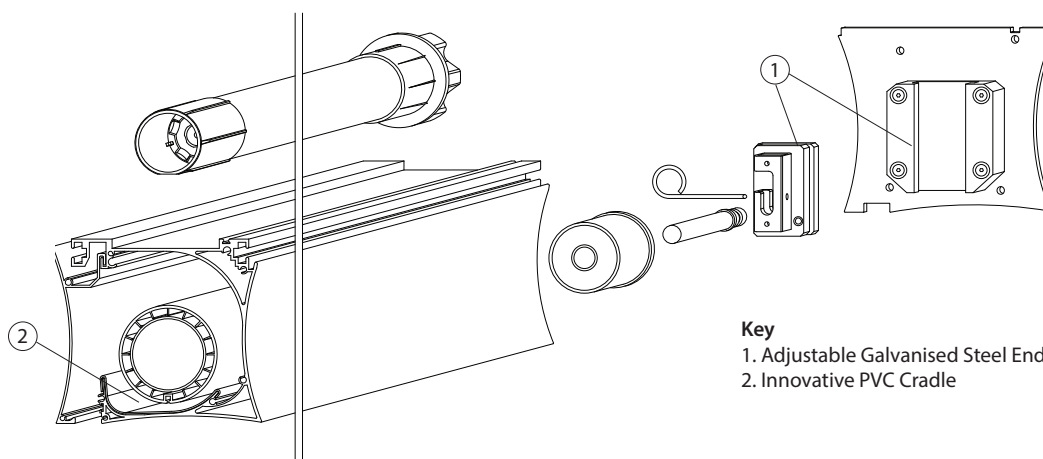

#### Key

1. Adjustable Galvanised Steel End Cap
2. Innovative PVC Cradle

# Securo® Max - Channel Guide



**Tube** : Aluminium  
Outer Tube Ø63mm  
Inner Motor Tube Ø50mm  
Roller Tube with Securo® Locking Groove

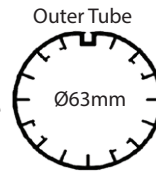

Inner Motor Tube

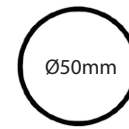

**Channel Guides** : Aluminium  
4 pieces on each side  
Channel Guide with Securo® Locking Groove  
Lip Seal  
Side Fix 25mm x 63mm  
Face Fix 33mm x 63mm

Side Fix

or

Face Fix

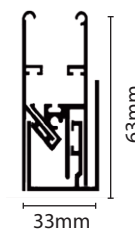
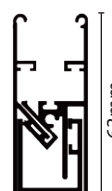

**Bottom Rail** : Aluminium  
Bottom Rail with Securo® Locking Groove  
Lip Seal  
Soft Touch

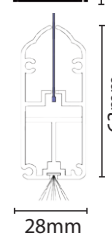

**Fixing Options** : Face Fix

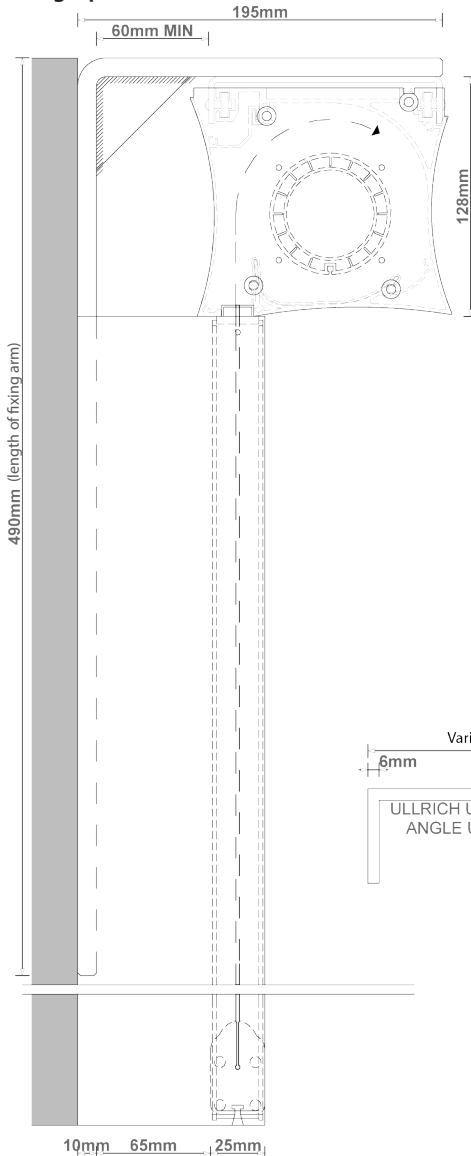

Top Fix

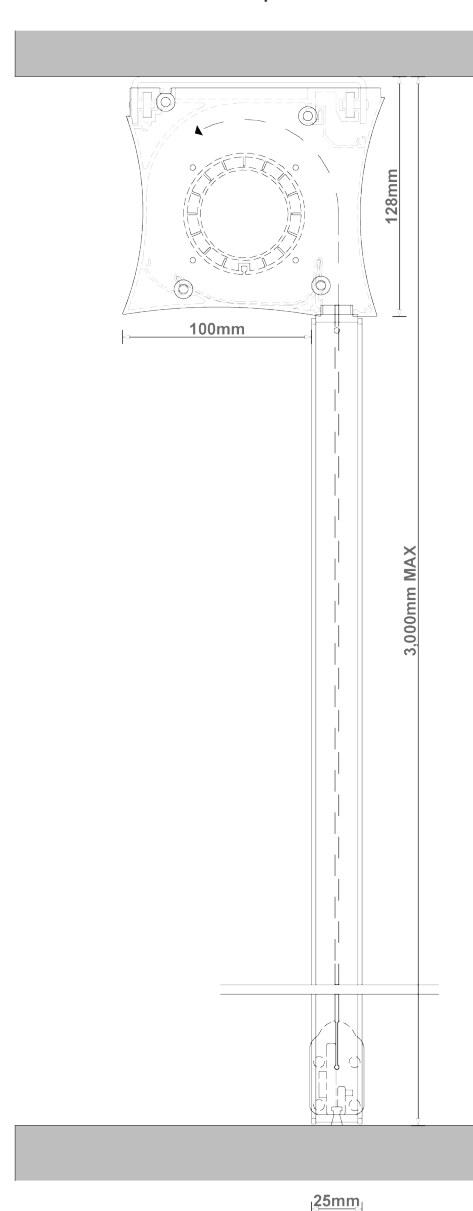

Sec. : Securo  
Date : Nov 2018

## Securo® Max Channel Guide Specifications

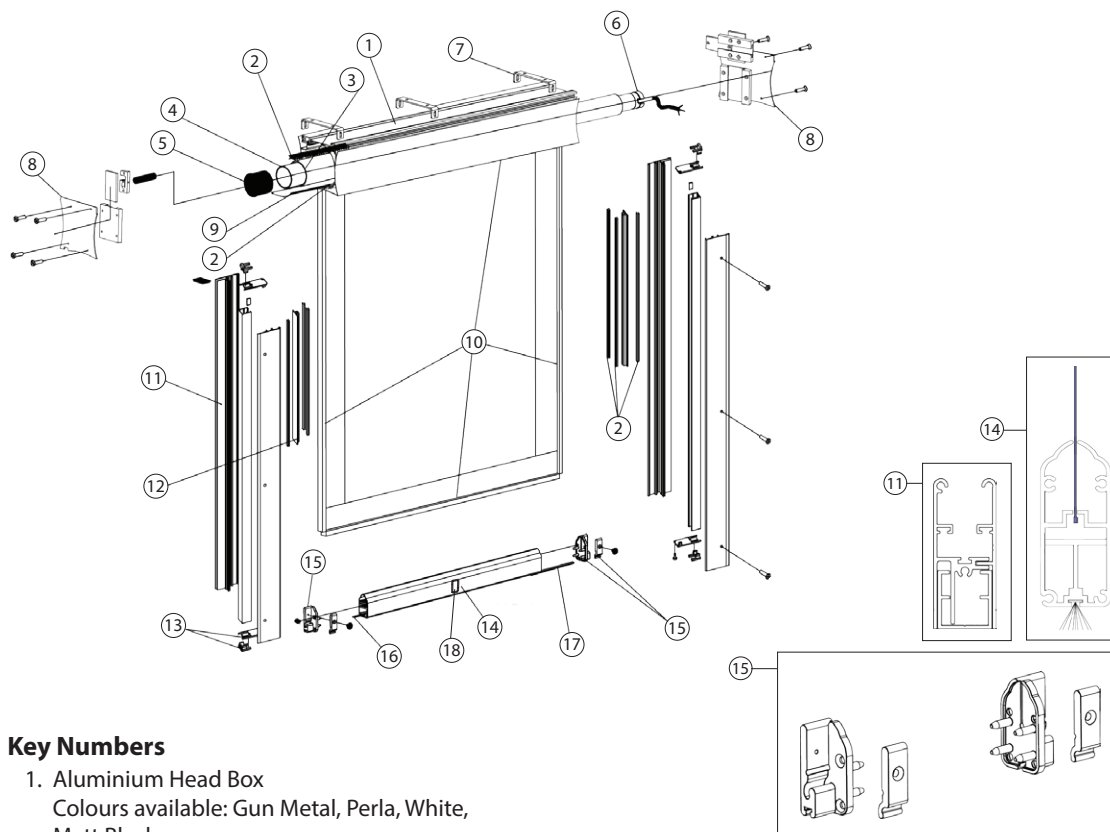

### Key Numbers

1. Aluminium Head Box  
Colours available: Gun Metal, Perla, White, Matt Black
2. Lip Seal
3. Aluminium Roller Tube Ø 63mm with Securo® Locking Groove
4. Aluminium Roller Tube Ø 50mm for electric 220 V Somfy Motor
5. Round Hub Pivot Ø10mm
6. Somfy Motor 220 V
7. Zinc Plated Wall Ceiling Fixing Bracket
8. Adjustable Galvanised Steel End Caps
9. PVC Cradle
10. Securo® Locking Groove (Head Rail, Channel Guides, Bottom Rail)
11. Aluminium Channel Guides (3 Profiles)  
Colours available: Gun Metal, Perla, White, Matt Black
12. Channel Guides PVC
13. Channel Guide Plastic End Caps
14. Bottom Rail Aluminium  
Colours available: Gun Metal, Perla, White, Matt Black
15. Bottom Rail Plastic End Caps
16. Galvanised Iron Plate
17. Soft Touch - Polybond Woolpile
18. Stabilising Bolt (optional) Stainless Steel

### Motorisation - Securo Max Channel Guide/Wire Guide

Motor Selection		<10m <sup>2</sup>	>10m <sup>2</sup>
Securo Max	RTS	Maestria 10/17	Maestria 25/17
	WT	Jet 10/17	Gemini 25/17

#### KEY:

WT = Mechanical switch hardwired to the motor.

RTS = Remote control (handheld or wallmounted)

Maximum Width: 10m, Maximum Drop: 3.0m

Performances	Maestria 10/17	Jet 10/17	Maestria 25/17	Gemini 25/17
Torque	10 Nm	10 Nm	25 Nm	25 Nm
Nominal Voltage	230v	230v	230v	230v
Rated Current	0.5 A	0.5 A	0.8 A	0.8 A
Rated Power	120W	120W	170W	170W
Speed	17 RPM	17 RPM	17 RPM	17 RPM
Thermal Protection	4 Min	4 Min	4 Min	4 Min
Radio Frequency	433.42	433.42	433.42	433.42
Sound Level (DB)		47		57
Cable Length	3000mm	2500mm	3000mm	2500mm
IP Rating	IP 44	IP 44	IP 44	IP 44
Insulation Class	I	I	I	I

Sunis Wirefree  
RTS Sun Sensor



Eolis RTS Wind Sensor    Soliris RTS- Sun & Wind Sensor



Sec. : Securo  
Date: Dec 2020

### Somfy Sensors

Weather Sensors can be used for automatic control. These include wind and sun sensors. Wind sensors will retract your awning if wind speeds exceed 35 km/h. The sun sensor works on light levels and can be programmed to a specific light level.



# Securo® Max - Wire Guide



## Securo® Max Wire Guide

Securo®Max wire guides are substituted for the Securo® channel guides. Wire guides are used where there isn't any end fixing to attach the channel guides to. The wire guides incorporate stainless steel wire, eye bolts, jaw/swage pipe turn-buckles, swage studs and drop in anchors.

The maximum size is 10m wide x 3.0m drop. Securo®Max Wire Guide when motorised, can be linked to a building management system, remote controlled and/or with wall switches and with optional light and wind sensors.

Window Treatments has a variety of fabrics for interior/exterior applications. For exterior applications, we recommend Techno X which is a durable and tough synthetic fabrics made of PVC coated polyester designed for outdoor use. For interior applications, the Securo®Max Wire Guide System can be used in conjunction with a variety of Sunscreen fabrics.

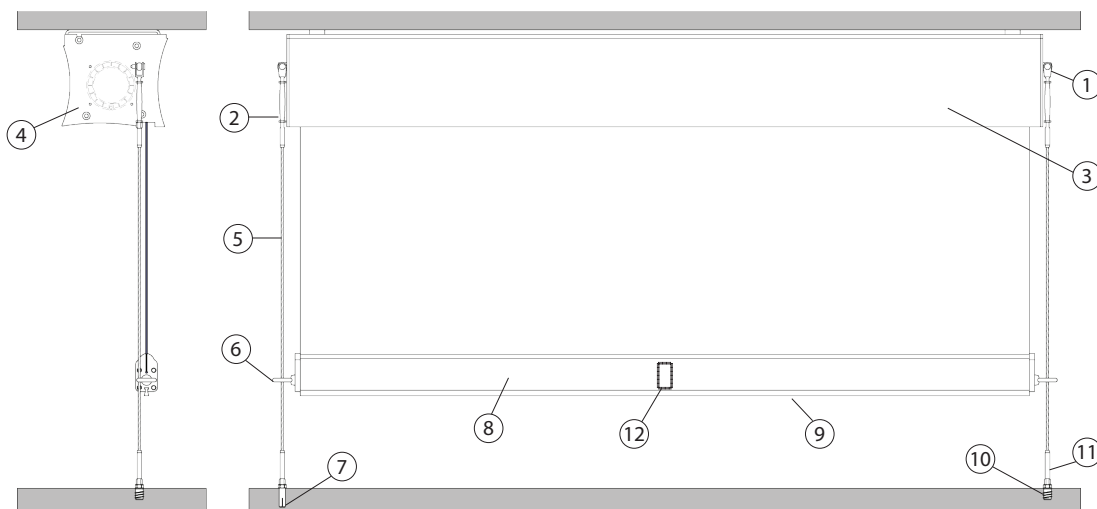

Side View - Head Box/Jaw/Swage Pipe

Front View - Jaw/Swage Pipe

Front View - Eye Bolt/Wire

Side View Bottom Rail

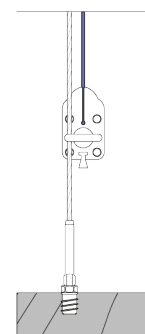
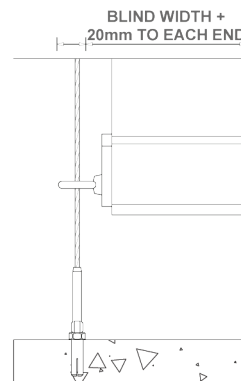
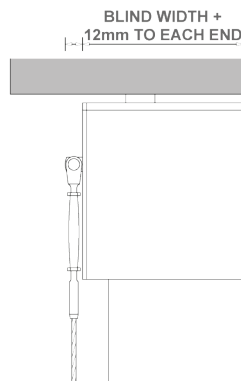
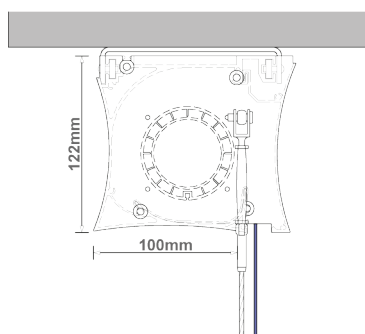

### Key Numbers

- |   |                                       |
|---|---------------------------------------|
| 1. Eyelet                                   | : Stainless Steel 316                 |
| 2. Jaw/Swage Pipe Turnbuckle                | : Stainless Steel S3121P M6/3.0       |
| 3. Head Box                                 | : Aluminium                           |
| 4. End Cap                                  | : Powder Coated over Galvanised Steel |
| 5. 3mm Stainless Steel Cable Wire           | : Stainless Steel 7 x 19 ASIST316     |
| 6. Eye Bolt                                 | : Stainless Steel 316                 |
| 7. Drop in Anchor (Concrete Fixing)         | : Stainless Steel 316                 |
| 8. Bottom Rail                              | : Aluminium                           |
| 9. Soft Touch                               | : Polybond Woolpile                   |
| 10. Counter Sunk Socket Screw (wood fixing) | : Stainless Steel 316                 |
| 11. Swage Stud                              | : Stainless Steel S7801 3mm x M6 316  |
| 12. Stabilising Bolt (optional)             | : Stainless Steel                     |

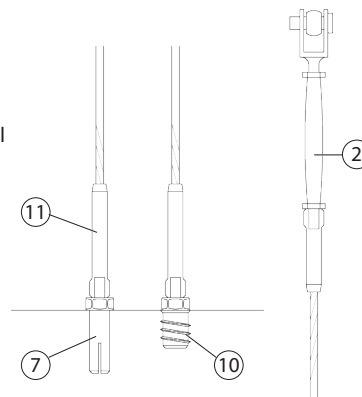

Sec. : Securo  
Date: Jul 2019

## Securo® Side Roll

Securo® Side Roll finally resolves the problem of achieving insect control whilst providing easy access through sliding doors and French doors. The solution utilises the Securo® fabric locking system with a spring loaded cassette/Head box roller blind but instead of rolling from the top to the bottom, it rolls from side to side.

The system has the added benefit of an "easy to use" brake so that the blind can be opened to any desired position. The brake handle is positioned on the sliding stile at normal door handle height.

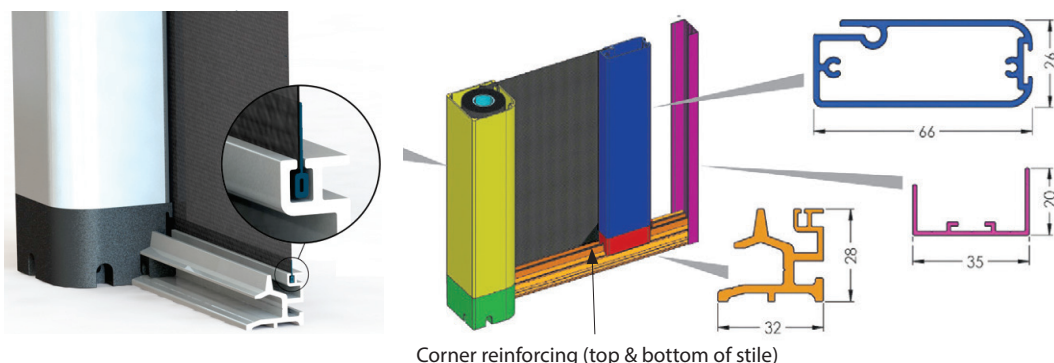

<b>Application</b>	: Interior and Exterior
<b>Maximum Size</b>	: Single screen - 4m W x 2.7m H or Double screen - 8m W x 2.7m H
<b>Operation</b>	: Sliding side to side with brake
<b>Fixing</b>	: Face Fix (recommended) or Top Fix (where Face Fix is not possible)
<b>Material Type</b>	: Interior - Phiferglass Pool & Patio Mesh Exterior - Phiferglass Pool & Patio Mesh
<b>Housing</b>	: Aluminium (60mm x 60mm, 70mm x 70mm or 80mm x 80mm). Fully enclosed one piece housing protecting the roller tube and fabric.

<b>Tube</b>	: Aluminium, 29mm and 35mm dia
<b>Track</b>	: (Top & Bottom) Aluminium 32mm x 28mm

<b>Receiver</b>	: 35mm x 20mm
-----------------	---------------

<b>Stile</b>	: 66mm x 26mm
--------------	---------------

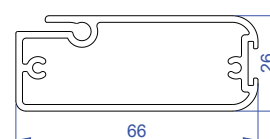
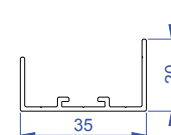
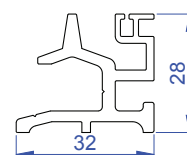
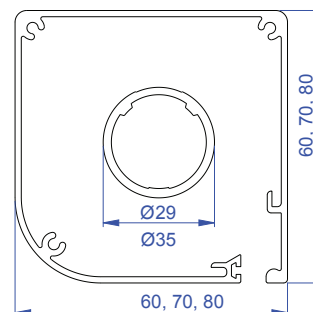

# Securo® - Side Roll



## Securo® Side Roll - Installation Options

### Recess Track Option

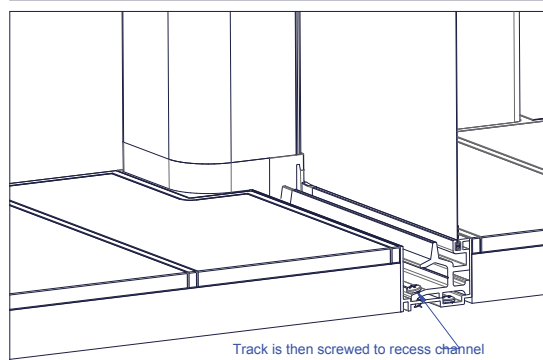
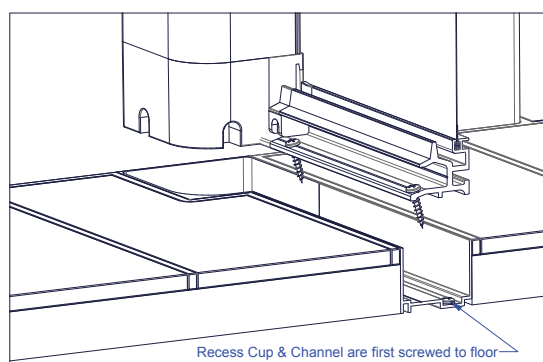
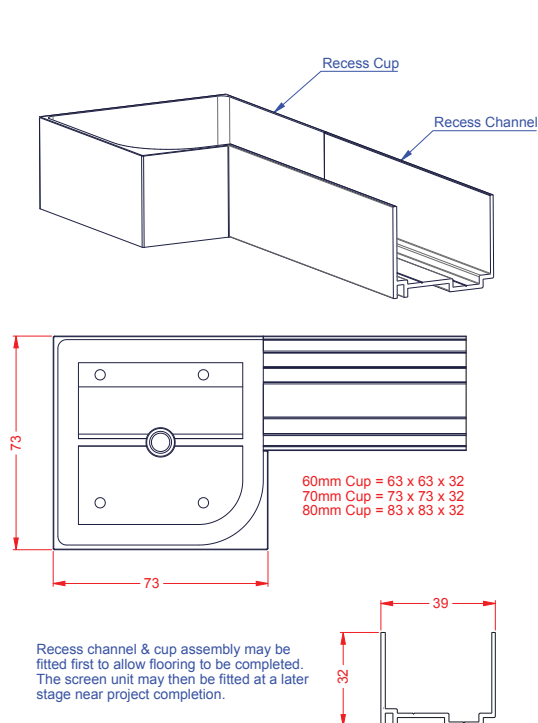
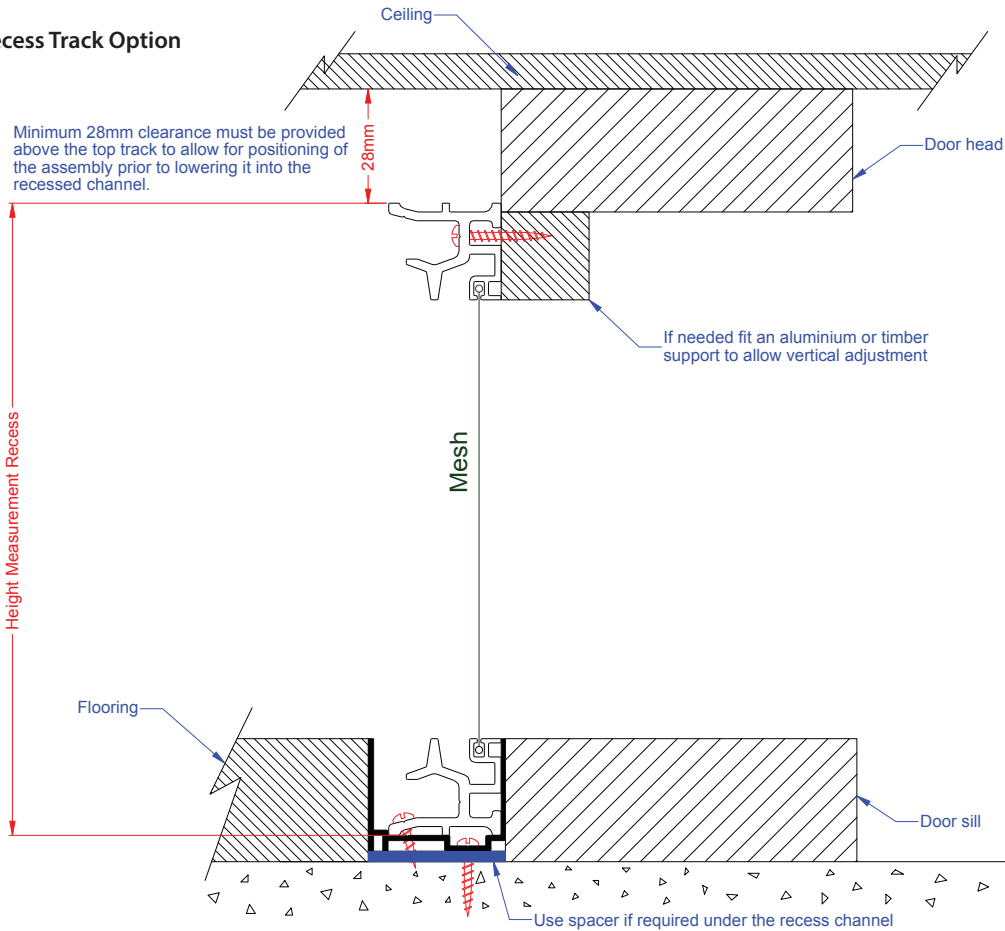

Sec. : Securo  
Date : Aug 2016

## Options for Face Fix and Top Fix (inside door/window jamb)

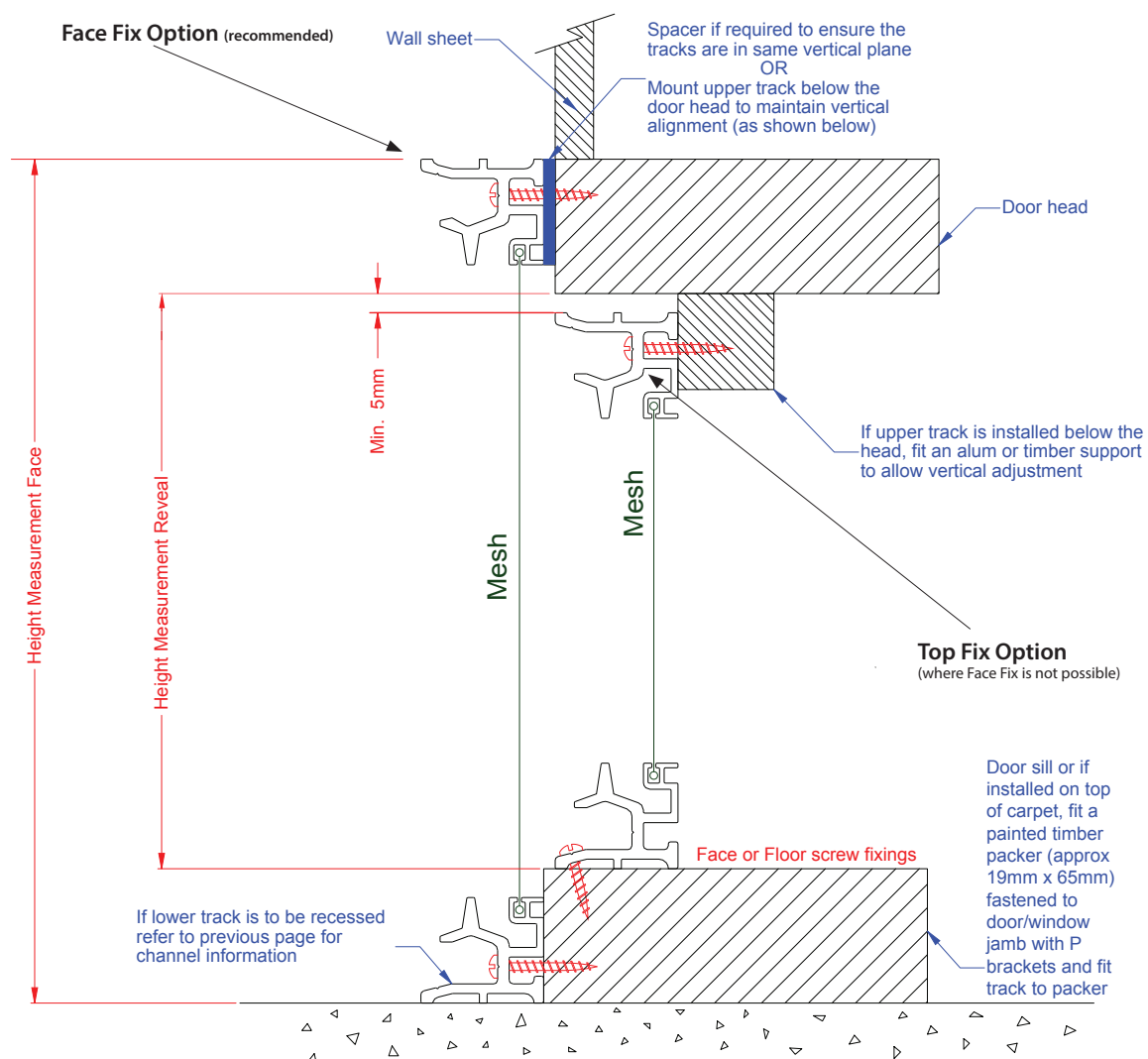

## Double Screen

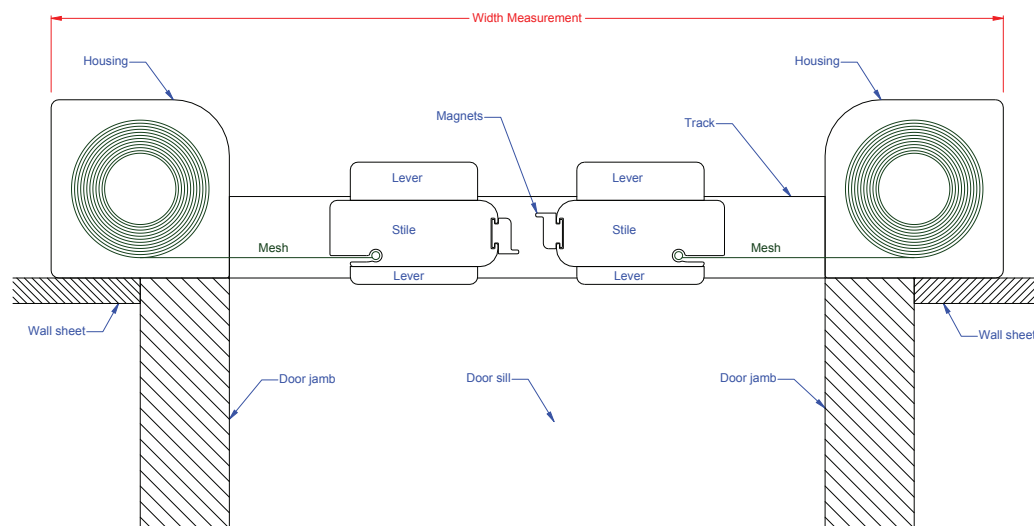



# Securo® - Side Roll



## Exterior Sliding Stacking Doors

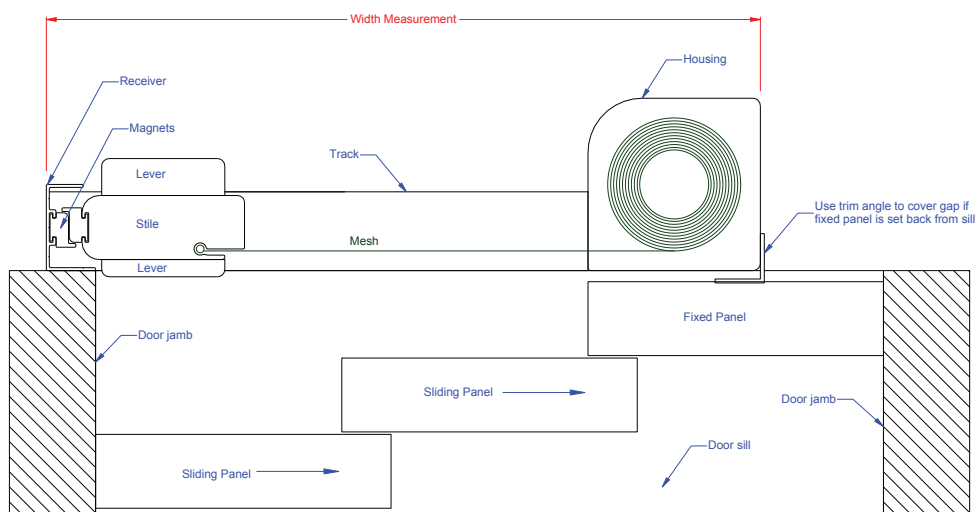

## Exterior Bi-Fold Doors

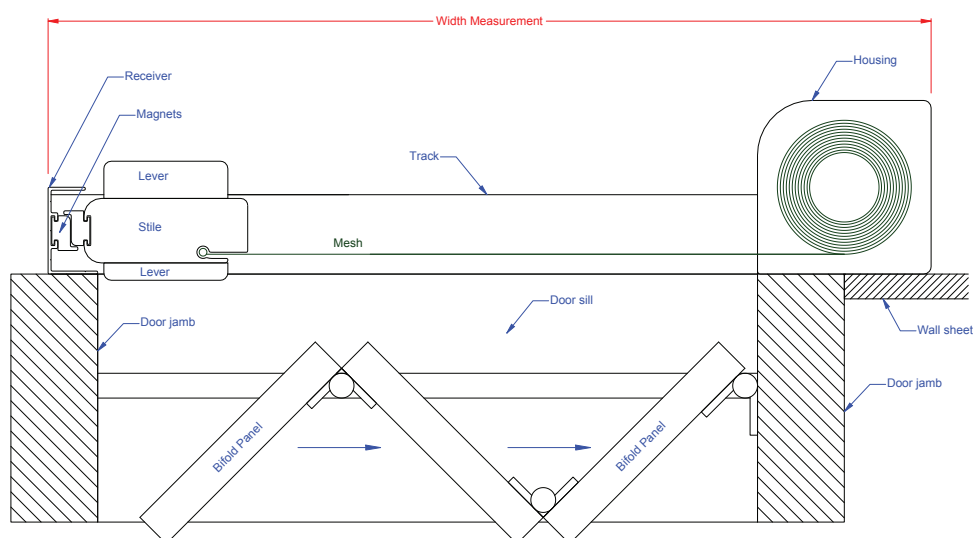

## Internal Corner

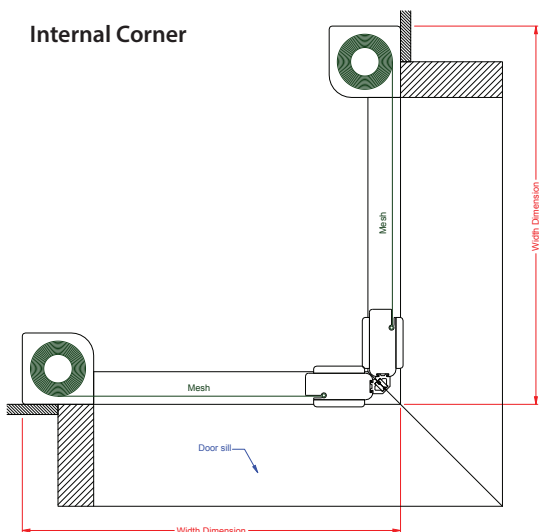

## Exterior Corner

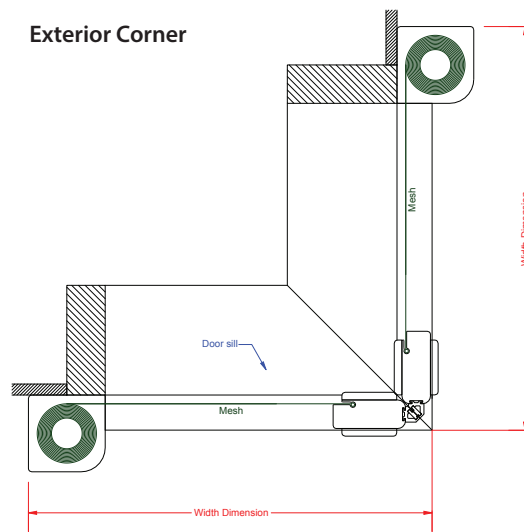

SPECIFICATIONS

Sec. : Securo  
Date : Aug 2016

# Securo® - Side Roll

## Securo® Side Roll

Size Limits		
Housing	Single	Double
<b>60mm</b> Phiferglass Pool & Patio Mesh	Up to 1600mm width x 2700mm drop	Up to 3200mm width x 2700mm drop
<b>70mm</b> Phiferglass Pool & Patio Mesh	Up to 2800mm width x 2700mm drop	Up to 5600mm width x 2700mm drop
<b>80mm</b> Phiferglass Pool & Patio Mesh	Up to 4000mm width x 2700mm drop	Up to 8000mm width x 2700mm drop

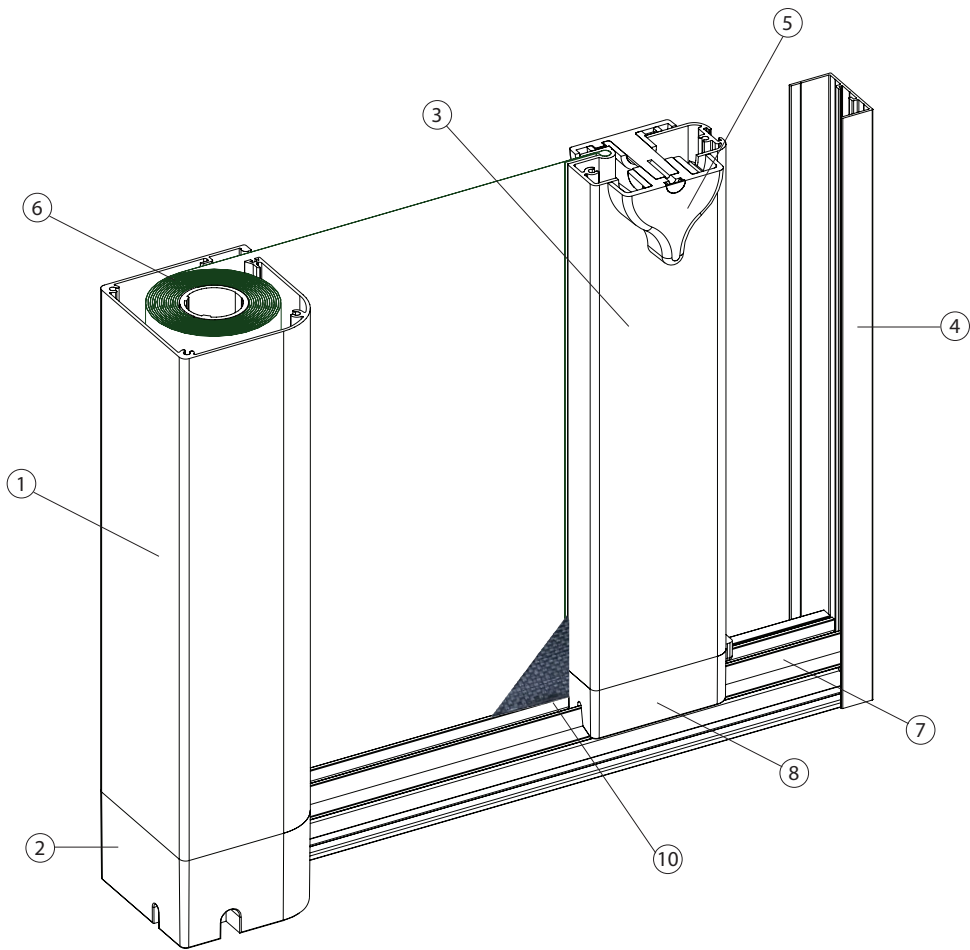

### Key Numbers

- |   |             |
|---|-------------|
| 1. Housing  | : Aluminium |
| 2. End Cap  | : PVC       |
| 3. Stile  | : Aluminium |
| 4. Receiver   | : PVC       |
| 5. Brake Handle                                     | : PVC       |
| 6. Tube   | : Aluminium |
| 7. Track  | : Aluminium |
| 8. Stile Cap and Brake                              | : PVC       |
| 9. Magnet   | : Magnet    |
| 10. Corner Reinforcing on Stile side (top & bottom) |             |

### Note:

- Colours available for Key numbers (1, 3, 4, 7) are : Gun Metal, Perla, White, Matt Black
- Colours available for Key numbers (2, 5, 8) are : Black, White

Sec. : Securo  
Date : Dec 2020

## Fabric Overview



The Window Treatments range of fabrics offers endless opportunities when used in commercial or domestic internal applications. We supply various fabrics which comprise of intelligent energy saving screen fabrics, ecologically friendly, fire retardant, PVC free, mould and mildew resistant, light-filtering to block-out fabrics. For all fabrics, specifications are available on request.

### Sunscreen:

The Techno Screen range is very cost effective and works well in both commercial and domestic situations. Techno Screen is dimensionally stable and comes in a wide range of colours in both 5% and 3% openness. Both Screen ranges are fire retardant.

### Light-filtering Fabrics:

Our light filtering fabrics provide more privacy than screen fabrics but still allow you to enjoy ambient light. The lighter the fabric colour the more ambient light you will achieve in the room. 100% polyester and acrylic coated, the Filtra range is also PVC Free.

### Block-out Fabrics:

We carry an extensive range of block-out fabrics, some with a textured finish and others with foam or white flocked acrylic backing. These fabrics are ideally suited for computer rooms, offices, home theatre and bedrooms as they prevent glare and provide complete block-out when required. Most of our block-out fabrics are PVC free and all are resistant to mould and fungi, making block-out blinds ideal for installations in areas of high humidity and moisture.

### Exterior Fabric:

When using **Securo® Wire Guide** for exterior applications, we recommend Techno X which is a durable and tough woven vinyl coated polyester core yarn that is formulated to withstand solar damage.

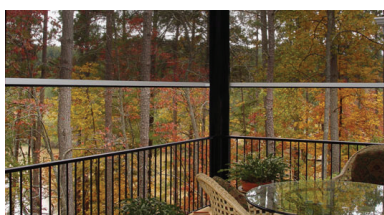

### Fabric Types:

Fabric Type	Maximum Width	Maximum Drop without Weld	Maximum Drop with Weld	Internal	External
<b>Securo® Pull Down Blind</b>					
Phiferglass Pool & Patio Mesh	2.40m	2.0m		Yes	Yes
Soltis 88 Screen	2.10m	2.0m		Yes	Yes
Soltis 99 Screen	2.10m	2.0m		Yes	No
Icon FR Blockout, Duo Block	2.10m	2.0m		Yes	No
<b>Securo® Channel Guide 75</b>					
Techno X	3.9m	1.3m		Yes	Yes
Block-out	3.9m	1.3m		Yes	No
Enviroshade & Filtra	3.9m	1.3m		Yes	No
*Clear PVC	3.9m	1.3m		Yes	Yes
<b>Securo® Channel Guide 110</b>					
Techno X	4.6m	3.0m		Yes	Yes
Block-out	4.6m	2.7m		Yes	No
Enviroshade & Filtra	4.6m	2.4m	3.0m	Yes	No
Clear PVC	4.6m	1.37m	2.7m	Yes	Yes
<b>Securo® Max</b>					
Techno X	10m	3.0m		Yes	Yes
**Techno Screen	10m	3.0m		Yes	No
<b>Securo® Side Roll</b>					
Phiferglass Pool & Patio Mesh	4.0m	2.7m		Yes	Yes

\* PVC is available but not recommended due to the drop limitations of the 75mm head box

\*\*For Securo® Max blinds exceeding 3000mm wide Techno Screen is railroaded and a disclaimer is required.



# Securo® - Fabric

## Techno X Solar Screen

### Solar Screen Fabric 3% Openness

When using **Securo® Wire Guide** or **Securo® Max Wire Guide** for exterior/interior applications we recommend **Techno X Solar Screen**. This fabric is a tough woven durable polyester yarn that is formulated to reduce heat transfer through windows before it reaches the glass. This fabric also reduces the glare and harmful rays from the sun. Flame resistant and fade resistant, **Techno X Solar Screen** is a durable alternative for insect screen. Excellent for daytime privacy without blocking the view, this versatile fabric will endure years of outdoor use. **Techno X Solar Screen** blocks up to 95% of the sun's rays.

Techno X Solar Screen	
Composition	30% Polyester, 70% PVC
WEIGHT g/m <sup>2</sup>	550
Thickness mm	0.70
Openness Factor	3%
Light Fastness & Standard	Grade 8, ISO105 B02-1994
Flammability (FR) / Ignitability Index & Standard	BS5867 Part 2 Type B NFPA 701:2015 TM #2

Techno X Solar Screen				
Colour:	Tv	Ts	Rs	As
Black	11%	7%	3%	90%
Slate	12%	8%	9%	83%
Stone	15%	13%	43%	44%

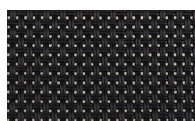

Techno X Fabric -  
Black,  
also available in  
Slate & Stone

## CERTIFICATE OF COMPLIANCE



**CHANGZHOU BESTEX  
TECHNICAL TEXTILE  
CO., LTD**  
P4001-P4299

Report No.  
Certificate Number  
0181524081 - 101012019  
Certificate Period  
Status

UL 2818 - 2013 Standard for Chemical Emissions for Building Materials, Finishes and Furnishings



Environment



Environment

## Insect Screen

### Composition :

Phiferglass Pool & Patio Mesh  
- A woven fibre glass coated  
with PVC.

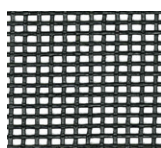

Physical Properties	Warp	Fill	Test Method
TENSILE STRENGTH A. Cust strip method (lb) B. Grab Method (lb)	160 165	128 128	ASTM D 5035 ASTM D 5034
TEARING STENGTH Trapezoid Method (lb)	16	15	ASTM D 5587
YARN SLIPPAGE (lb)	46	41	ASTM D 4912
STIFFNESS (mg)	258	210	ASTM D 3656
MESH WEIGHT (oz/sq yd)	4.4		ASTM D 3776
FABRIC THICKNESS (inch)	0.016		ASTM D 1777
BOND STRENGTH (lb)	36		CS 248-64
OPENNESS/TRANSMITTANCE (%)	56.4		I7
BLOCKING	Scale 1		FS L-S-125B
COLOURFASTNESS to 1200hrs Colour Change According to AATCC Gray Scale	All colours 4 min		TMS-TM-003
Mullen Bursting Strength (psi)	196		FS L-S-125B

## Clear PVC

### Composition

PVC Super Clear  
sheet laminated  
0.75mm

Thickness

Physical Properties		1.0mm x 48PHR	0.8mm x 46PHR	Test Method
TENSILE STRENGTH (kg/cm <sup>2</sup> )	MD	278.1	253.8	ASTM D-882
	CD	230	223.1	
ELONGATION (%)	MD	350	338	ASTM D-882
	CD	387	385	
TEAR STRENGTH (kg/mm)	MD	8.2	8.5	ASTM D-1004
	CD	8.7	8.0	

Sec. : Fabric  
Date : May 2021